

# SR111

## AR111 SORAA LED

MANUFACTURED IN THE UNITED STATES - IBEW



PRODUCT LISTED  
BY A NATIONALLY  
RECOGNIZED  
TESTING  
LABORATORY



This 12.5 Watt Soraa AR111 lamp. It produces a tight, narrow beam at 9° with a crisp edge. It is ideal for hospitality, restaurant, retail and artwork lighting. It is available with 95 CRI, and has a light output that mirrors a 75 Watt 12V AR111 lamp.

By utilizing Soraa's Snap System, there are unlimited possibilities for customizing this fixture. Options include the ability to field change the beam angle (Beam Spreader Snap), alter color temperature (CTO Snap), or to add a louver. Color Snaps can be used to produce brilliant hues of any color that Rosco or Lee offer.

The Enhance Lens Snap can increase the vividness of warm colors (including red, orange and pink and greens). Aim Snaps can bend the beam to a maximum deflection angle of 20°. Linear Snap Lenses can alter the beam to act as a wall wash.

Additional fixture features include an internal self-locking yoke, adjustable head and hinged front for easy re-lamping. Internal accessory holder accepts louvers, barndoors, hoods and a variety of filters. Available in standard black, white and silver finishes. Custom colors are available by request and at an additional charge.

### FEATURES

- 120, 220 and 277-volt available
- Integral 12-volt dimmable driver
- Use with electronic low voltage (ELV) Dimmer only (AKA Trailing Edge and Reverse Phase)
- Available in 2700K and 3000K.
- Beam angles of 9d, 25d, 36d, and 60d
- Rated life of 35,000 hours
- Numerous mounting options and accessories
- Dimmable
- Weight: 2 lbs

LAMP TYPE	WATTS	CRI	LUMENS *
Vivid	12.5	95 (R9=95)	1000

\* Lumens vary depending on color temperature - results for 3000K lamp used above.

### FINISH

B	Black
W	White
S	Silver
CC	Custom Color

### CONNECTOR TYPE / PLUG TYPES (OPTIONAL)

ED	Edison Connector
TL	Twist Lock Connector
SP	Stage Pin Connector

# SR111

AR111 SORAA LED

MANUFACTURED IN THE UNITED STATES - IBEW

PRODUCT LISTED  
BY A NATIONALLY  
RECOGNIZED  
TESTING  
LABORATORY

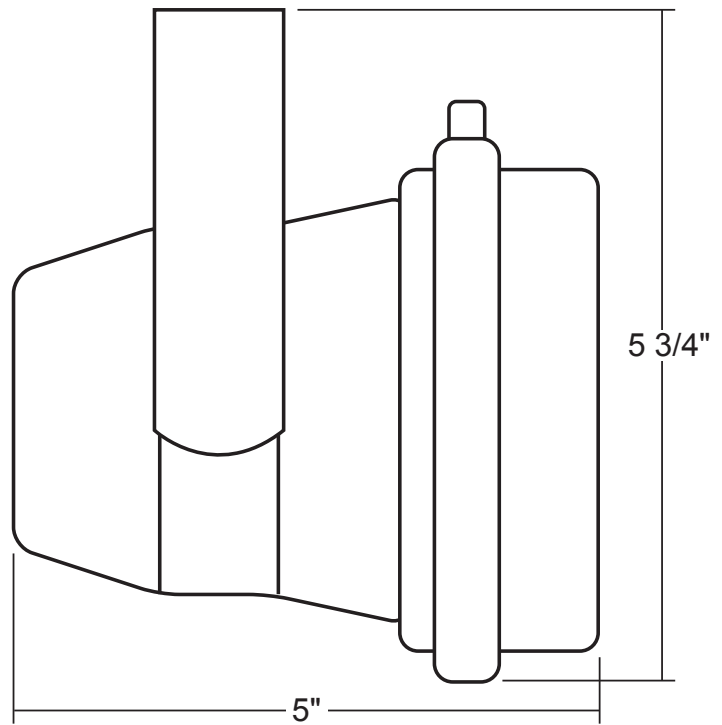
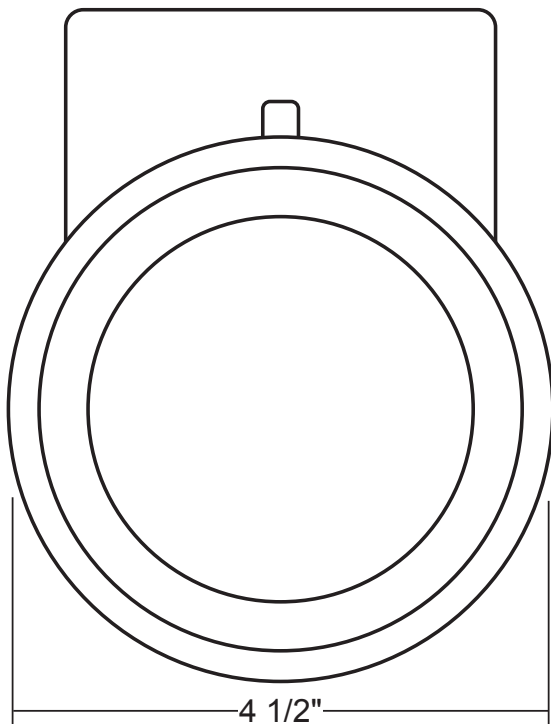

## PHOTOMETRIC DATA

### 9° Degree Beam

Distance	Beam Spread	Footcandles
3'	0.8'	2436
6'	1.7'	717
9'	2.5'	344
12'	3.4'	201
15'	4.2'	115

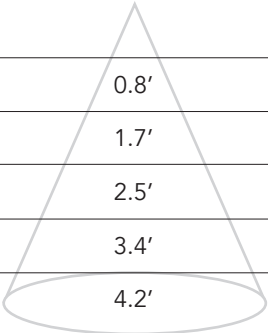

### 25° Degree Beam

Distance	Beam Spread	Footcandles
3'	2.2'	552
6'	4.4'	161
9'	6.6'	77
12'	8.7'	45
15'	10.9'	26

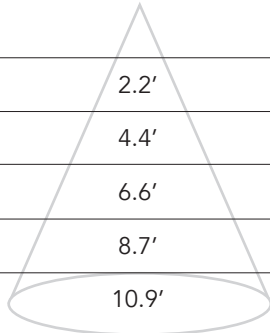

### 36° Degree Beam

Distance	Beam Spread	Footcandles
3'	3.5'	255
6'	6.9'	74
9'	10.4'	36
12'	13.9'	21
15'	17.3'	12

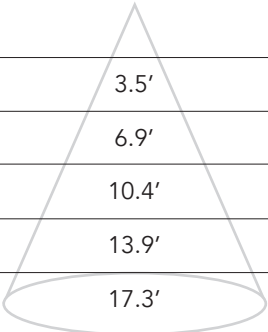

### 60° Degree Beam

Distance	Beam Spread	Footcandles
3'	6'	112
6'	12'	33
9'	18'	16
12'	24'	9
15'	30'	5

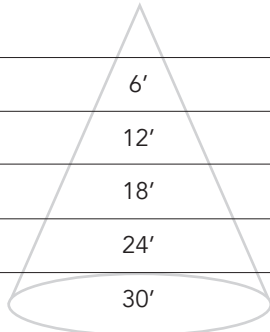

# SR111

## AR111 SORAA LED

MANUFACTURED IN THE UNITED STATES - IBEW



### MOUNTING OPTIONS

**AD1** Track Adapter for commercial grade 1-circuit track. 120V. For use with lightweight fixtures.

**DT2** Track adapter for SpecTrack 2-Circuit data track. 120V.

**HDT2** Track adapter for SpecTrack 2-Circuit data track. 277V.

**TA2 / HTA2 (277)** Track adapter for G-Series specification grade 2-circuit track. 120V or 277V.

**TA3** Track adapter for G-Series specification grade 3-circuit track. 120V.

**CM1** Canopy mount

**US1** 6 5/8" x 1 1/2" Unistrut adapter.

**TB4** 6 1/4" Portable wall mount/table base floor, wall or table use.

**TB8** 8" x 8" Portable table base for floor or table use.

**MC** Light duty pipe clamp for small fixtures. For pipes up to 1 5/16" O.D.

**MN** Medium duty pipe clamp for small to large fixtures. For pipes up to 2" O.D.

### EXTENSION WANDS

SP 12	12" Stem
SP 18	18" Stem
SP 24	24" Stem
SP X	Custom Length

### FIXTURE ACCESSORIES

LV6	Louver
XL6	Cross Baffle Louver
BD10	Barndoor
HD6	Hood
XH6	Cross Baffle Hood
CC18	Coiled Cord
SC-24	Safety Cable
WL	Wrench Locking

### SNAP ACCESSORIES

01145	25° Beam Spreader Snap
01147	36° Beam Spreader Snap
01149	60° Beam Spreader Snap
01595	10°-36° Linear Snap
03261	10°-60° Linear Snap
01597	36° x 36° Flat Top Snap
01151	40° Cutoff Louver
03257	20° Maximum Deflection Snap
01153	1/4 Color Temperature Shift Snap
01155	1/2 Color Temperature Shift Snap
01157	3/4 Color Temperature Shift Snap
03283	Enhance Snap
02185-C	Color Snap (Specify Color)

### NOTES ON DIMMING

Visit [tslight.com/resources](https://tslight.com/resources) or scan the QR Code.



# SPECIFY:

MODEL	CRI	COLOR TEMPERATURE
SR111	95	27 = 2700K 30 = 3000K
COLOR	MOUNTING OPTIONS	ACCESSORIES
B = Black W = White S = Silver CC = Custom Color	See Mounting Options for Ordering Codes	See Accessory Options for Ordering Codes

\* All fixtures sold with 9° beam angle lamps – use Beam Spreaders to achieve desired angle.

# ORDERING INFORMATION

PROJECT:	
LOCATION:	
QUANTITY:	
CONTACT:	
PHONE:	
EMAIL:	

EXAMPLE: SR111-9527-B-AD1-LV6

MODEL	CRI	COLOR TEMPERATURE	COLOR	MOUNTING	ACCESSORIES
SR111					